

County Surveyor's Record, Tillamook County Oregon

CHAINS

RESTORED CORNER FOR STATE OF OREGON-DEPARTMENT OF FORESTRY

One Quarter corner common to Sections 21 and 28, T3S, R8W, W.M., Tillamook County, Oregon.

ORIGINAL

Post (missing) from which a:

- 5" Fir bears N28E 60 lks.; now 36", scribe 1 visible, rest unexposed.
- 8" Alder bears S33W 42 lks.; now 16" uproot, face and scribes rotted away.

RESTORED

Var. 21 $\frac{1}{2}$ E

Set $1\frac{1}{2}$ " x 36" galvanized iron pipe with 3" bronze cap marked "OREGON STATE BOARD OF FORESTRY 1/4 S21 S28 1961 RS401", 34 inches in ground, and from which a:

- 32" Fir bears N76E 11.3 ft.; scribed 1/4 S21 BT.
- 40" Fir bears S2E 14.3 ft.; scribed 1/4 S28 BT RS401.

Oregon State Board of Forestry metal location poster on 32" Fir BT.
Set 4" x 4" x 52" white painted Cedar post 1.0' N.W. of pipe.

Dated November 10, 1961

Restored by Harold J. Russell under my direction.
Harold Russell, Engineering Tech.

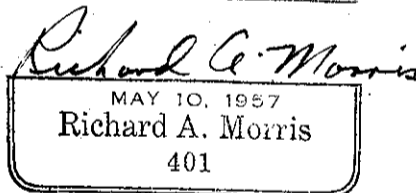
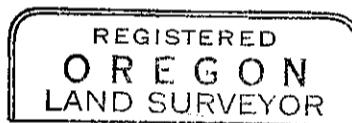

Present and witnessed by A. Duncan
D. Spiesschaert

*1/4 Cor
S. BURY
21-3-S.8*